

**220 East Madison Street
Tampa, Florida**

**OFFICE SPACE FOR LEASE
NEW ON THE MARKET**

- **High-Rise Office Building**
- **Excellent Downtown Tampa Location**
- **Competitive Lease Rates**
- **Full Service Leases**
- **Suites Available:
150 sf To 9,000 sf**
- **Ongoing Renovation**
- **Record Storage Space Available**
- **Corporate Identity Available For Key Tenant**



For Further Information Contact:

LEANNE HAMILTON-SMITH
Leanne5842@aol.com

THE KRAUSS ORGANIZATION
Commercial Real Estate Services • Since 1952

711 North Sherrill Street
Tampa, FL 33609-1109
(813) 885-5656 Office
(813) 281-2356 Fax
www.thekraussorg.com

NOTICE TO BROKERS AND PROSPECTIVE PURCHASERS/TENANTS:

THE MATERIAL CONTAINED IN THIS OFFERING IS FURNISHED SOLELY FOR THE PURPOSE OF YOUR CONSIDERATION TO PURCHASE/LEASE THE PROPERTY CONTAINED HEREIN, AND IS NOT TO BE USED FOR ANY OTHER PURPOSE WITHOUT THE EXPRESS WRITTEN CONSENT OF THE KRAUSS ORGANIZATION OR THE OWNER. THE MATERIAL IS BASED ON INFORMATION OBTAINED BY OWNER AND ON INFORMATION OBTAINED BY THE KRAUSS ORGANIZATION FROM SOURCES THEY DEEM RELIABLE. THIS IS A SUMMARY OF PERTINENT FACTS ON THE PROPERTY AND IS NOT INTENDED TO CONTAIN ALL OF THE INFORMATION DESIRED BY A PROSPECTIVE PURCHASER/TENANT. PROSPECTIVE PURCHASERS/TENANTS SHOULD MAKE THEIR OWN INVESTIGATION AND CONCLUSIONS WITHOUT RELIANCE UPON THE MATERIAL CONTAINED HEREIN. NEITHER OWNER NOR THE KRAUSS ORGANIZATION, NOR ANY OF THEIR OFFICERS, EMPLOYEES OR AGENTS MAKE ANY REPRESENTATION OR WARRANTY EXPRESSED OR IMPLIED AS TO THE ACCURACY OR COMPLETENESS OF THIS OFFERING.

220 East Madison Street Tampa, Florida

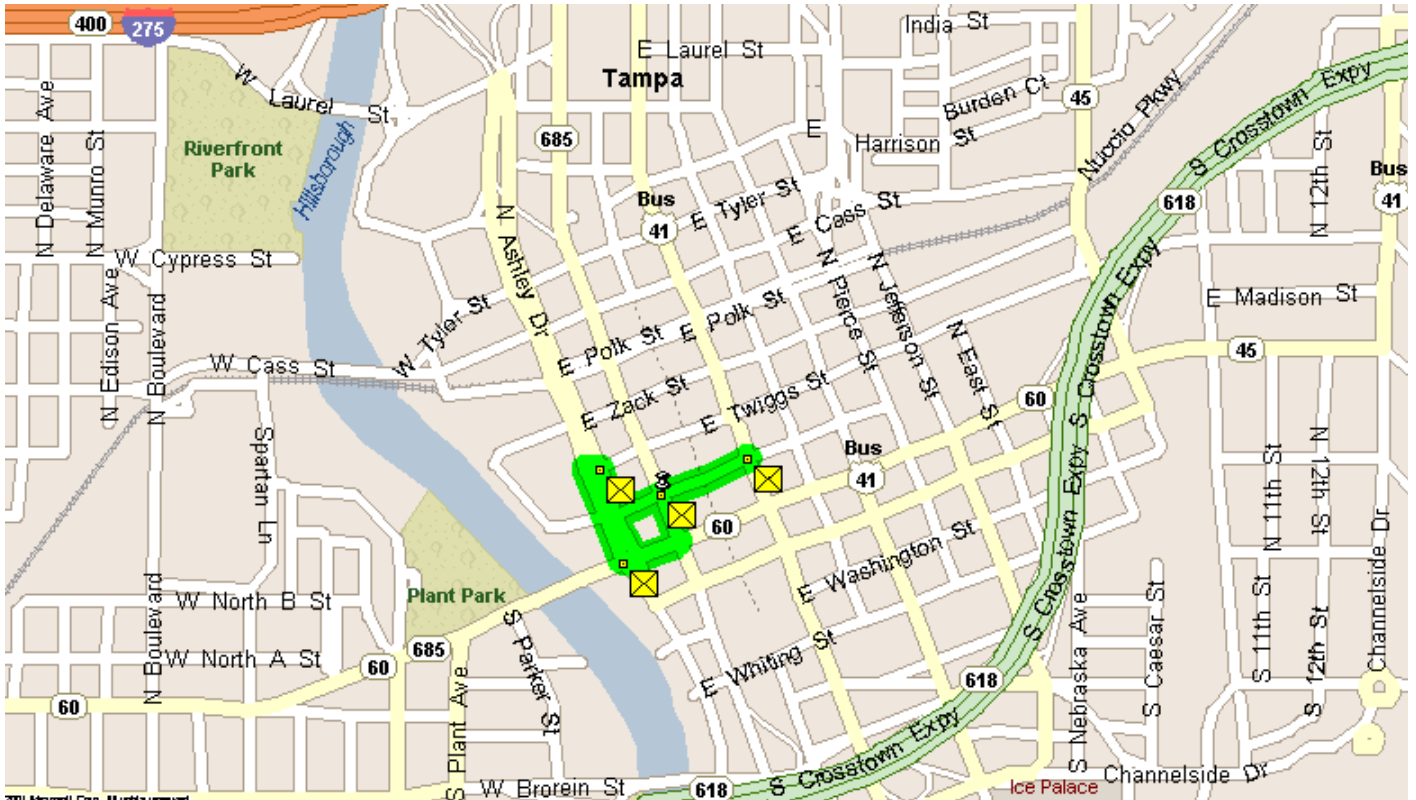
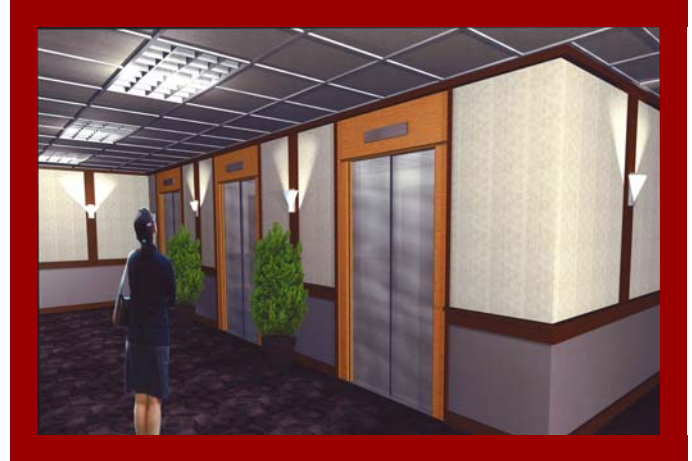

Public Parking Lot